

Hand-operated accelerators for mounting in cab.

Either self and no-self actuating return mechanism.

Lever position feedback is provided by a contactless sensor connected to either an analog or PWM signal circuit, depending on the variant.

The no-load state can be detected either by an optocoupler or mechanically via a microswitch, according to the application.



※ The lever can be adapted to meet specific customer requirement.

SPECIFICATIONS

PRODUCT LIFE	FULL TRAVEL CYCLES	2 MILLION
ELECTRONICS	SEAL INTEGRITY	IP67
	EMI	SAE J1843 Compliant
ELECTRICAL	OPERATING VOLTAGE	5, 12, 24, 48 72Vdc as requested
	OUTPUT SIGNAL	Single, Dual output, PWM, CAN Bus as per SAE J-1939
PEDAL ANGLE	DEGREES	30°
MECHANICAL	OPERATING FORCE	To be adjusted as per customer's request
	VIBRATION	8 Hour, 3-Axis, Random Broadband up to 9G
ENVIRONMENTAL	OPERATING TEMP RANGE	-40°C to 85°C
	STORAGE TEMP RANGE	-40°C to 85°C
	HUMIDITY	After Exposed to -32°C ~ 70°C (96%)
	SAND/DUST	Tested to SAE-J 1455
MATERIALS	MAIN BODY	PA66+GF30%
	LEVER	SUS304

Part No. -

REVISION HISTORY

REV	DESCRIPTION	DATE	DR	RE	AP
0	Issued	31.Mar.20	M.J.Kim	J.I.Kim	J.H.Lee

Self-Holding, Changeable direction

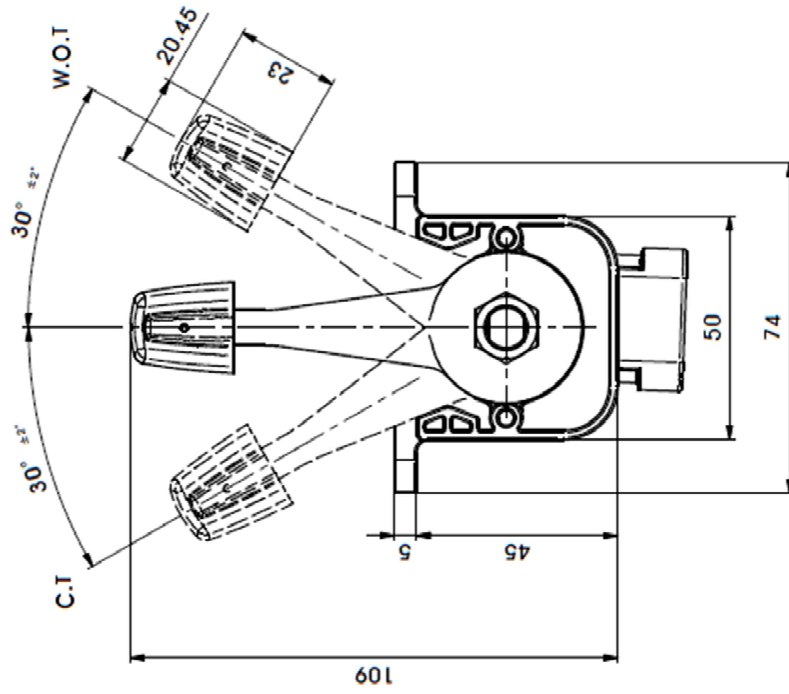

Knob Color : 566 Orange

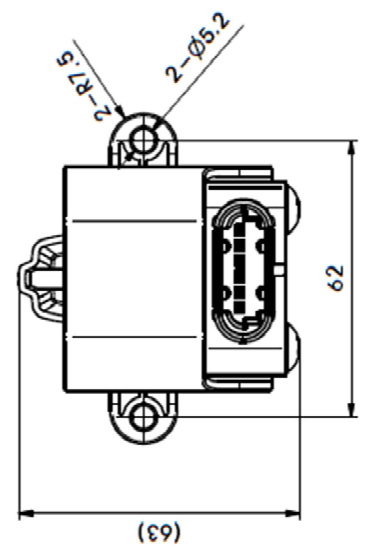
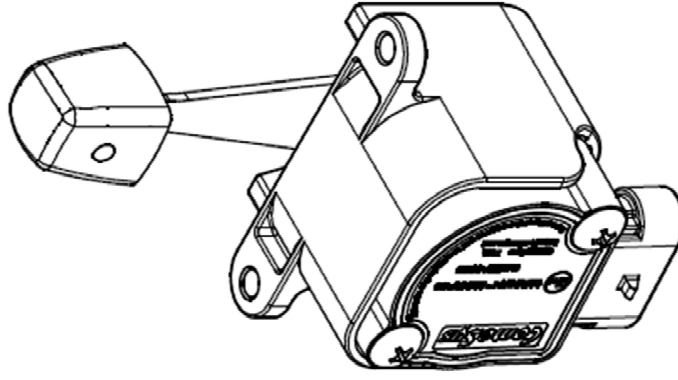
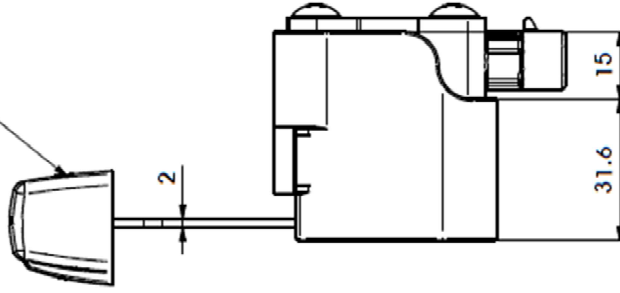

ComeSys		Control & Mechatronics Systems Limited		Name*	
Head Office: 100, Seongnam-Dong, Seongnam-City, Gyeonggi-Do, Korea		Seoul Office: 100, Seongnam-Dong, Seongnam-City, Gyeonggi-Do, Korea		Hand Throttle Accelerator Assy (MTH2)	
Representative: J.H. Lee		Sales: J.H. Lee		Approval No.:	
Tel: +82-31-900-1111		Fax: +82-31-900-1112		Date: 31.Mar.20	
E-mail: cs@comesys.com		Web: www.comesys.com		Revision: 0	
Address: 100, Seongnam-Dong, Seongnam-City, Gyeonggi-Do, Korea		Address: 100, Seongnam-Dong, Seongnam-City, Gyeonggi-Do, Korea		Drawing No.:	
Company Name: ComeSys		Company Name: ComeSys		Drawing Title:	
Company No.:		Company No.:		Drawing No.:	
Sheet 1 of 1		Sheet 1 of 1		Sheet 1 of 1	